

ISSUE	DATE	REVISION	PROJECT #
PROJECT			
CLIENT	DATE # SEPT 2025	DWG #	
	SCALE @ A3 1:25		FE-01
DWG	FLAT EMBOSSED - SECTIONAL DETAIL	DRAWN	
		CHKD	REVISION

DISCLAIMER: VERIFY ALL DIMENSIONS WITH THE GARAGE DOOR COMPANY LIMITED PRIOR TO MANUFACTURING AND COMMENCING WORK.

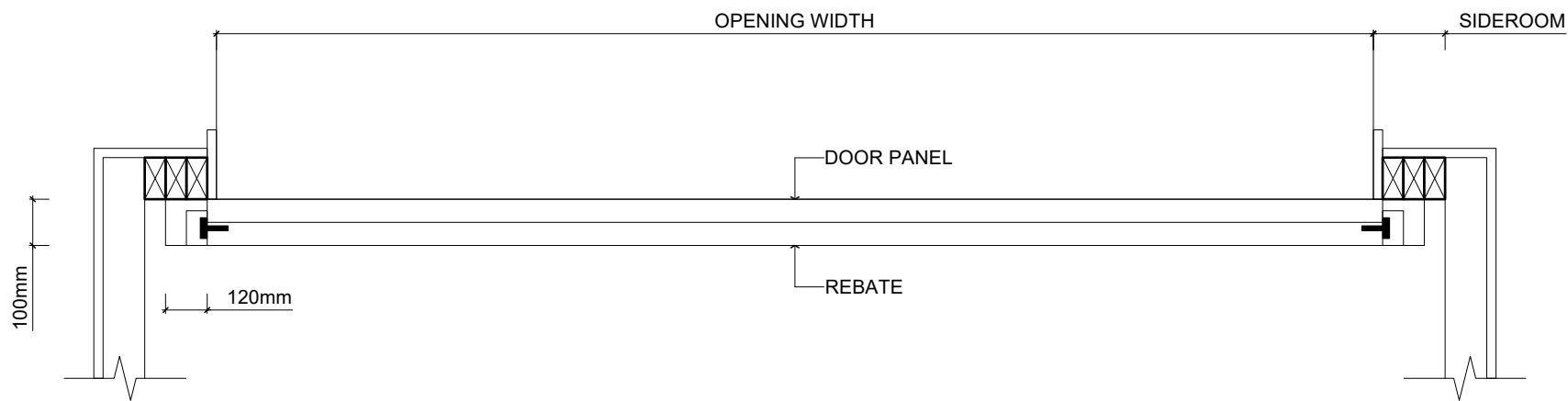

- NOTE: ALL INSTRUCTIONS ARE FROM THE INSIDE LOOKING OUT
1. ENSURE THAT THE DOOR OPENING AND THE SUPPLIER DOOR WILL FIT.
 2. THIS CAN BE DONE BY MEASURING THE HEIGHT OF ONE PANEL AND MULTIPLYING IT BY THE NUMBER SUPPLIED.
 3. ENSURE THAT YOU HAVE ATLEAST 120mm OF SIDE ROOM ON EACH SIDE AND 300mm OF HEAD ROOM BEFORE YOU CONTINUE.
 4. STANDARD DOOR CAN HAVE REDUCED HEAD ROOM ON REQUEST - CONTACT GARAGE DOOR CO.
 5. THE BACKSPACE SHOULD BE THE DOOR HEIGHT + 1.0m TO ALLOW FOR AUTOMATION AND DOOR HEIGHT + 150mm FOR A MANUAL DOOR.

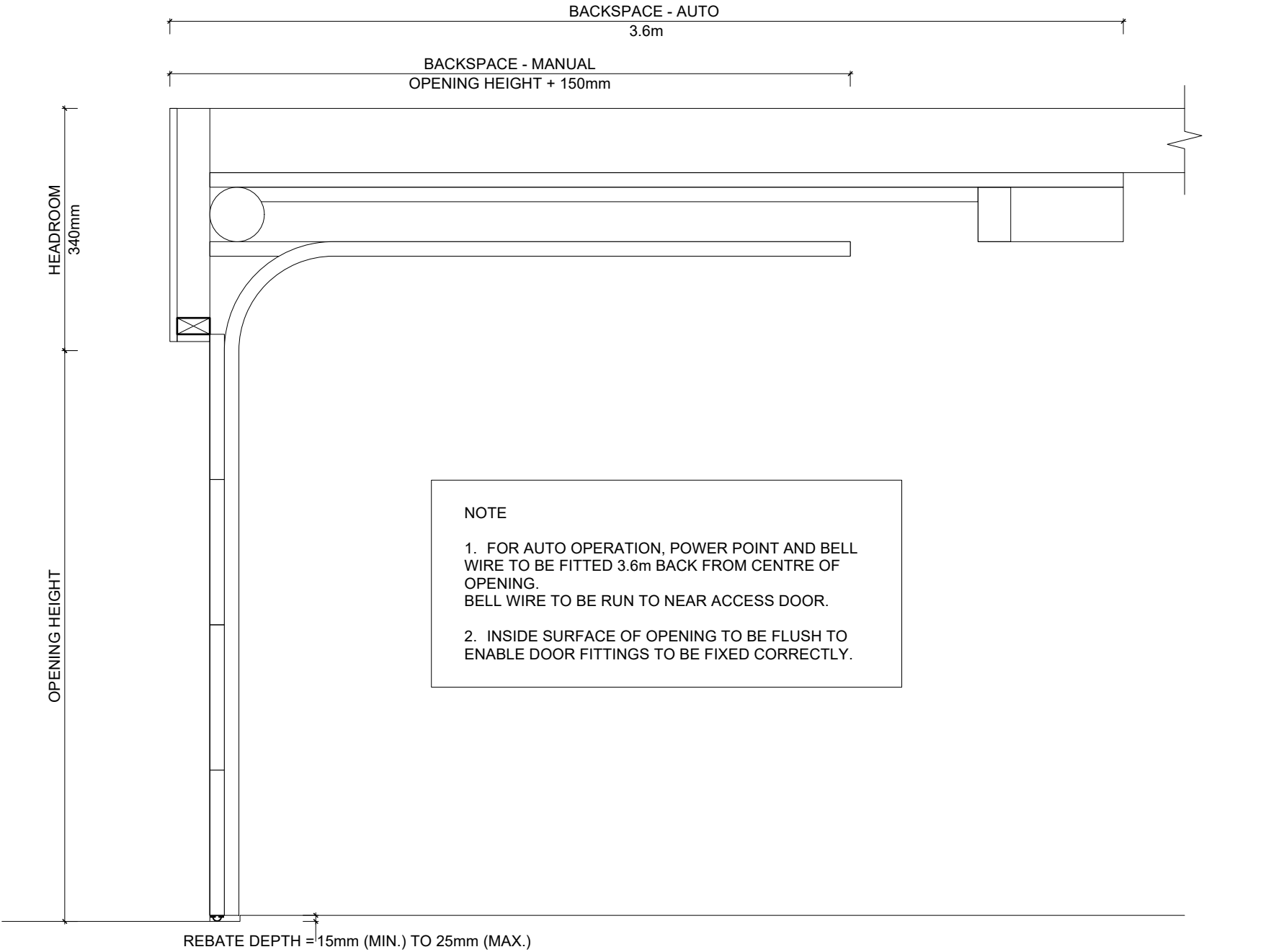

ISSUE	DATE	REVISION	PROJECT #
PROJECT			
CLIENT	DATE # SEPT 2025	DWG #	
	SCALE @ A3 1:25		FE-02
DWG	DRAWN	CHKD	REVISION
FLAT EMBOSSED - SET OUT			

DISCLAIMER: VERIFY ALL DIMENSIONS WITH THE GARAGE DOOR COMPANY LIMITED PRIOR TO MANUFACTURING AND COMMENCING WORK.